



Product Code

# R 517-1N3P-1EF

THIS PRODUCT HAS BEEN INSPECTED ACCORDING TO THE RONDA QUALITY SYSTEM AND IS ACCEPTED BY THE DEFINED SPECIFICATIONS AND STANDARDS.

Product Code

# R 517-1N3P-1EF

THIS PRODUCT HAS BEEN INSPECTED ACCORDING TO THE RONDA QUALITY SYSTEM AND IS ACCEPTED BY THE DEFINED SPECIFICATIONS AND STANDARDS.

## RONDA HONG KONG SWISS MOVEMENT

## RONDA HONG KONG SWISS MOVEMENT

### HOW TO SET THE DATE AND TIME FOR CALENDAR WATCHES

### HOW TO SET THE DATE AND TIME FOR CALENDAR WATCHES

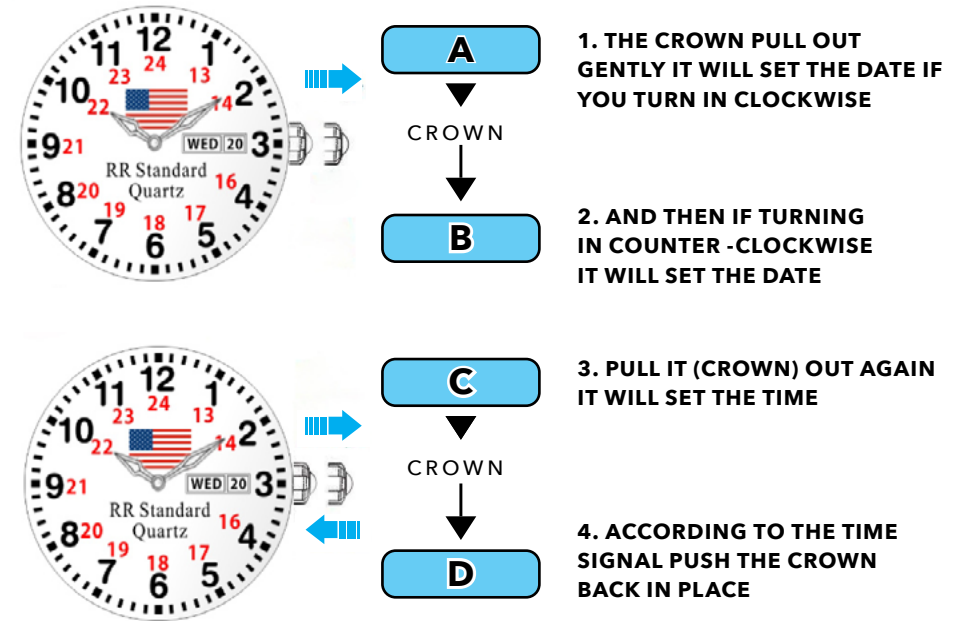
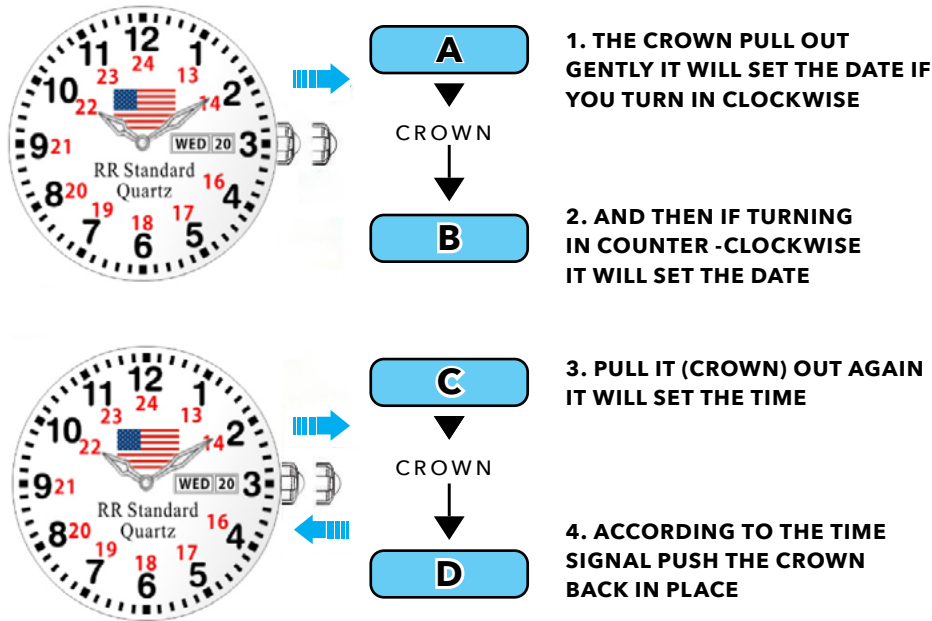

Pinnacle Awards Canada - Explanation of our Swiss Movement Railroad Watches

Pinnacle Awards Canada - Explanation of our Swiss Movement Railroad Watches

We are going to be upfront and honest on how we designed our custom USA trademark pending Railroad wrist watches. These watches are assembled in Canada for Pinnacle Awards Canada by Certified Licensed Swiss Watch Makers and Certified Railroad Watch Inspectors. Some watches that are "Swiss Made" may in fact consist of parts made in Asia. Pinnacle Awards Canada Railroad watches are of high standards and quality. Manufactured in the best Chinese and Hong Kong factories. These manufacturers have been producing many of the components under license for Swiss brands for decades.

We are going to be upfront and honest on how we designed our custom USA trademark pending Railroad wrist watches. These watches are assembled in Canada for Pinnacle Awards Canada by Certified Licensed Swiss Watch Makers and Certified Railroad Watch Inspectors. Some watches that are "Swiss Made" may in fact consist of parts made in Asia. Pinnacle Awards Canada Railroad watches are of high standards and quality. Manufactured in the best Chinese and Hong Kong factories. These manufacturers have been producing many of the components under license for Swiss brands for decades.